

PRIMARY SCHOOL

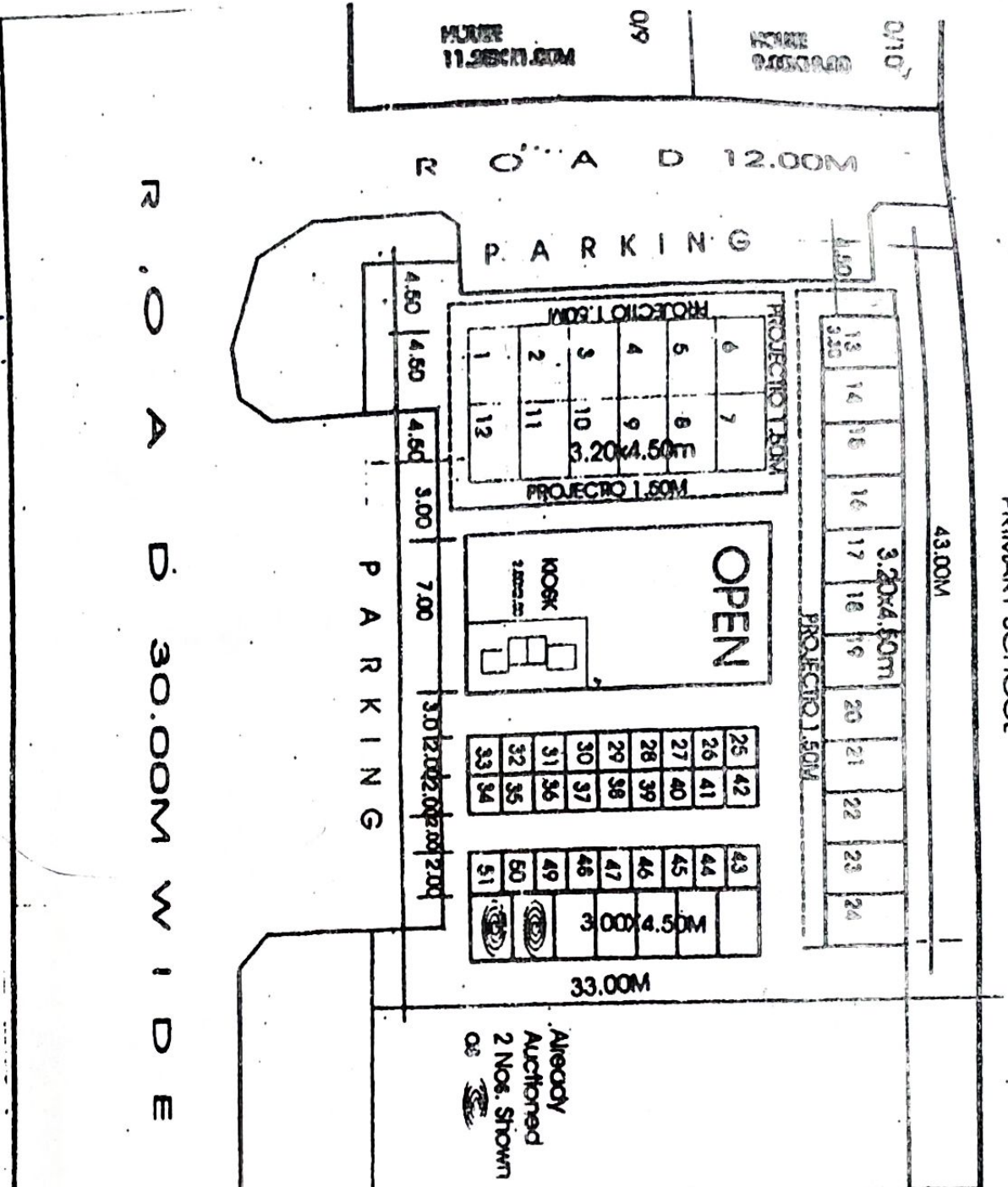

Already Auctioned 2 Nos. Shown

SCHEDULE OF SHOPS

SHOPS:-	
3.30X4.50.	1
3.20X4.50	23
2.00X2.00	27
3.00X4.50	7
KOSKS-	
2.00X2.00	4

PROPOSED SHOPPING CENTRE
SECTOR NO.1 NEAR SHIVE
KUTIA R.H.B. HANUMANGARH

DRG NO. R.H.B./M.H.	SCALE:
DATE:-	FILE NO.
DRAWN:- H.R.Godara	
DR. H.C. Circle R.H.B. Bikaner	Resident Engineer R.H.B. Hanumangarh
RAJASTHAN HOUSING BOARD	

M.S.M.
Narinder Sharma
Rajasthan Housing Board

DEEN

RE RAJHM

COMMERCIAL PLOT FOR AUCTION.

C.S. SECTOR No 8

PLOT 30X180M

R O A D 180M W I D E

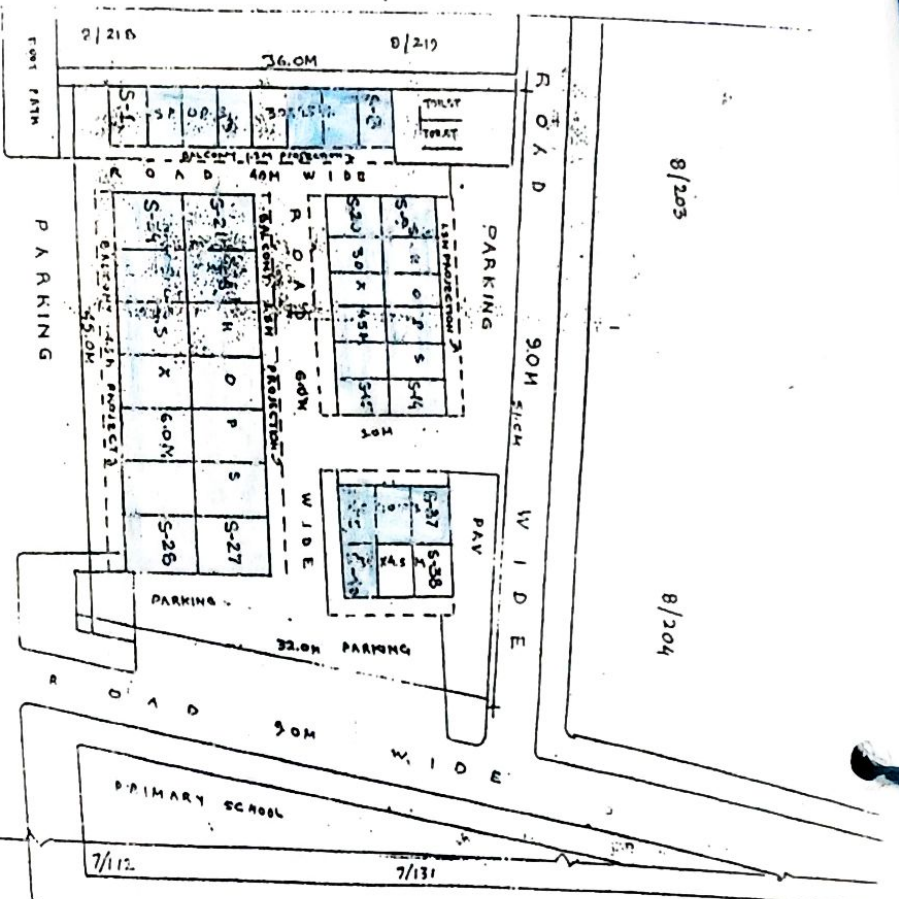

C.S. SECTOR No 7

PLOT 30X180M

R O A D 180M W I D E

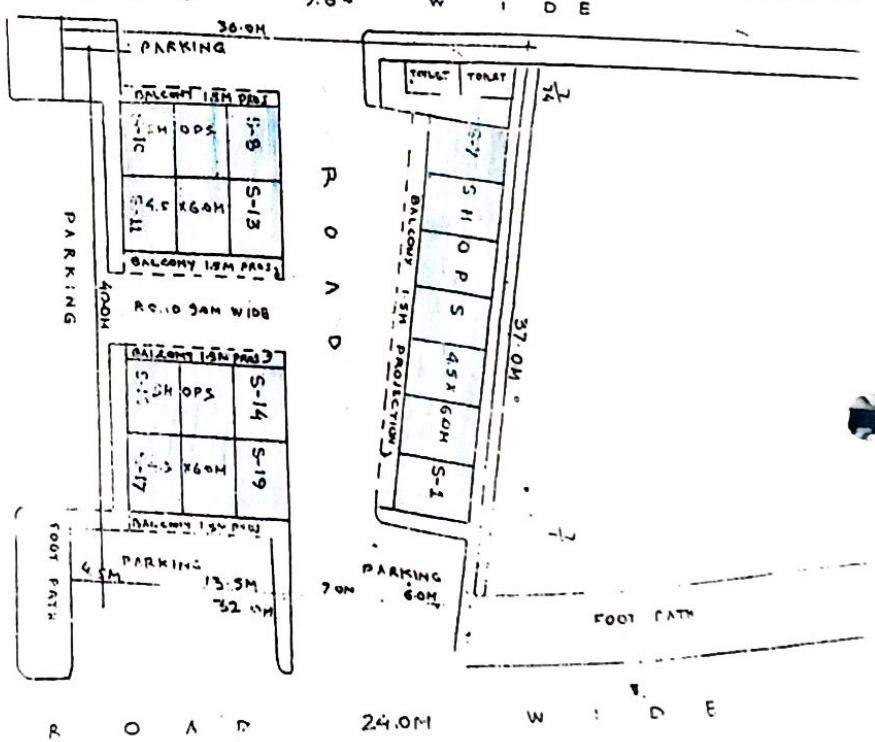

SCHEDULE OF SHOPS

Sl. No.	SHOP TYPE	SECTION NO	SIZE	TOTAL
1	SHOP I	45X60M	19	19
2	SHOP II	30X45M	14	26
				40

PROPOSED C.S. SECTOR No 7 & 8 AT HANUMAN GARH

DRG NO. RNS/HC
DATE: 18.5.2004
DRAWN BY: B.S. RAJPOHIT
SCALE: 1:250
FILE NO.
CHECKED BY

DIWAN: SINGH
ASSISTANT ARCHITECT

100

