



URBAN IMPROVEMENT TRUST KOTA

Near CAD Circle Kota

Phone No. 0744-2500539

website : uitkota.abcprocure.com

No. F11/Auction/2016/ 238

Date :- 13-5-16

Opportunity to Purchase Plots through e-auction

E-Auction

Urban Improvement Trust Kota is auctioning plot No. R-5 for Resort in Pandit Madan Mohan Malviya Scheme Kheda Jagpura Kota through -E-Auction from 16-5- 2016. The plot is situated on main road NH-12 near RTO Office. It is close to Kota city towards Jhalawar Road. The auction will close at 10 am on 20-5-2016 (subject to automatic extension of bid in case of bidding in last 5 minutes) The number of is plot 1 (One). Details of Plots scheme map, size, EMD, and further comprehensive details may be accessed on uitkota.abcprocure.com

Chief Account Officer

1. Auction Details:-

Sr. No	Description	Remarks
1	Plot No R-5 : Pandit Madan Mohan Malviya Scheme Kheda Jagpura Kota	16124.84 Sqmt (Approx)
2	Participation fee	Rs 500.00
3	EMD	Rs 15.00 Lacs
4	Bidding Date & Time Start	16-5-2016 Time 5.00 PM
5	Bidding End Date & Time	20-5-2016 Time 10.00 AM
6	Bid Starting Price (BSP)	6150 Per Sqm mtr.

2. Scheme Map:- Plot No : R-5

3. Technical Specification :-

- Set Back :- Plot No R-5**
- Front : 30.00 Mtr.
 - Back : 15.00 Mtr
 - Side-1 : 15.00 Mtr.
 - Side-2 : 15.00 Mtr.
 - Max Height : As per Point 9.00 mt. of Building Byelaws
 - With permission of State Govt. Extra FAR = 0.4
 - Covered Area:-20%
 - Other Specification : As per Building Byelaws 2013 (Revised)

4. Feature of the Plots:

1. On Main Road NH -12
2. Near Newly launched Farm House Scheme.
3. Near RTO Office
4. Near Kota City
5. Nearby Institutional area of RIICO
6. Near Residential Scheme of UIT Kota

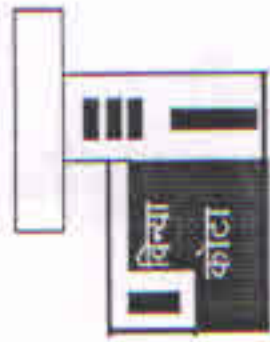

Plot No - R-5

Auction Scheme at Pandit Madan Mohan Malviya Kheda Jagpura Kota

Area- 16124.84 sqm. (approx)

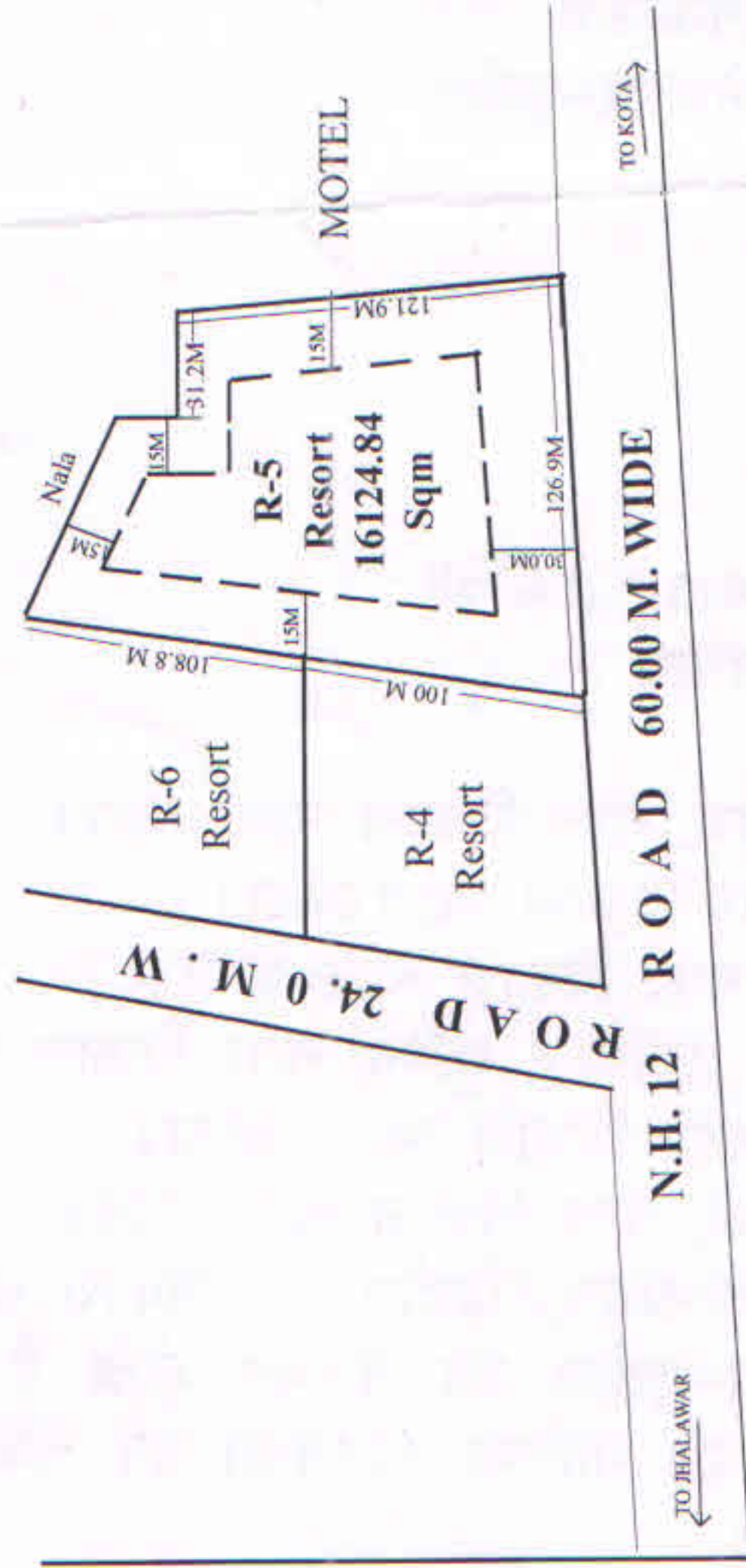

AREA OF PLOT NO. 4 = $\frac{1}{2} \times 127.7 \times 100 = 12770$
 " " R-5 = $\frac{1}{2} \times 34.3 \times 52 = 8918$ SQ. M
 = $\frac{1}{2} \times 52 \times 56 = 1456$
 = $\frac{1}{2} \times 56 \times 19 = 532$ SQ. M
 = $\frac{1}{2} \times 126.9 \times 90.2 = 5712.51$
 16124.84 SQ. M

NOTE:- SITE PLAN PREPARED AS PER
 MEASUREMENT GIVEN BY JEN C.R. MEENA

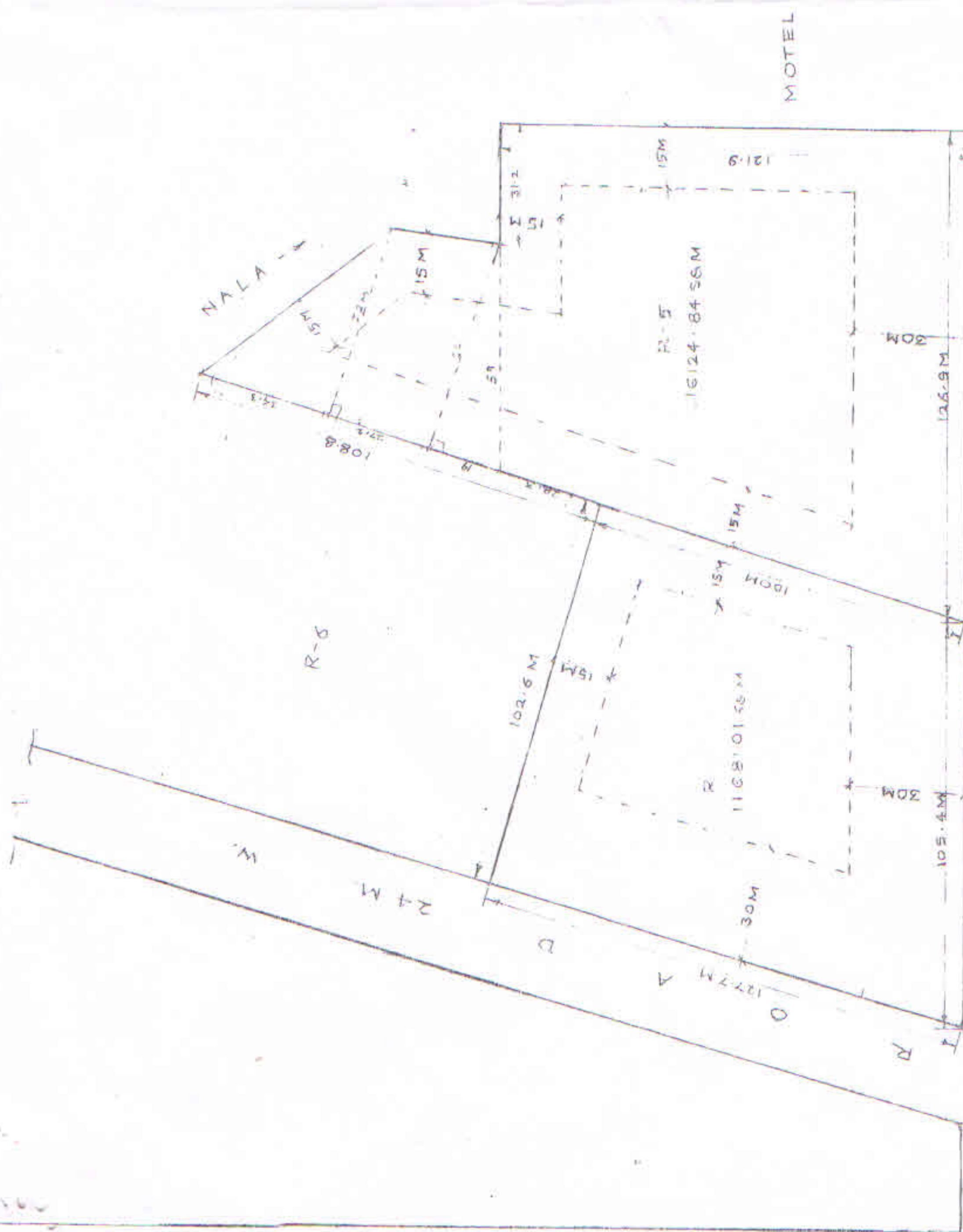

SITE PLAN OF RESORT NO.
 AT PANDIT MADAN MURARI
 MALVIYA SCHEME AT KHERA
 JAGPURA JHALAWAR ROAD KOTA

MEASURED BY <i>GSB</i>	PROJECT NO. 118 OF 2016
DRAWN BY <i>S. M. Sharma</i>	SCALE 1CM = 10M
CHECKED BY <i>S. M. Sharma</i> 13/5/16	ASST. TOWN PLANNER U.I.T. KOTA.

TO JHALAWAR TO KOTA

R O A D 60M.W.